



Slew Drives

**SLD SERIES**
**TECHNICAL SPECIFICATION**

- ⚙️ **Torque range:** 1.000 ÷ 70.000 Nm
- ⚙️ **Gear ratios range:** 1:3,4 ÷ 1:2.000
- ⚙️ **Input configurations:** flanged and cartridge axial piston hydraulic motors, hydraulic orbit motors
- ⚙️ **Output configuration:** flange mounted
- ⚙️ **Output shafts:** splined or with integral pinion
- ⚙️ **Brake:** DC and AC type electric brake; hydraulically released parking brake on request

		Model							
		SLD	010	018	025	05A	05B	075	090
Max. torque	Excavator	Nm	1.000	1.800	2.500	5.000	5.000	7.500	9.000
	Crane		1.200	2.400	3.500	6.500	6.500	10.000	15.000
Range of ratios			1:3,48 ÷ 1:7,2	1:3,48 ÷ 1:7,2	1:12 ÷ 1:44	1:12 ÷ 1:44	1:12 ÷ 1:44	1:15 ÷ 1:46	1:17 ÷ 1:47
Hydraulic motor speed			low	low	high	high	high	high	high
Max. input speed		rpm	500	500	3.000	3.000	3.000	3.000	3.000
Braking torque		Nm	50 ÷ 400	50 ÷ 400	50 ÷ 400	50 ÷ 400	50 ÷ 400	400 ÷ 1.000	400 ÷ 1.000
Design			A	A	A	A	B	B	B
Dimensions	D1	mm					180	200	230
	D2		150	150	175	175	195	250	280
	D3		195	195	245	245	245	325	314
	D4		220	220	272	272	290	360	348
	D5		186	186	245	245	245	292	345
	D6		12,5	12,5	18	18	13	17	
	L1		31	31	41	41	171	225	295
	L2		300	325	410	440	470	560	670
Weight		kg	22	27	45	50	80	95	140

SLD SERIES

TECHNICAL SPECIFICATION

		Model						
		SLD	120	180	20A	20B	400	700
Max. torque	Excavator	Nm	12.000	18.000	20.000	20.000	40.000	70.000
	Crane		20.000	30.000		35.000	55.000	80.000
Range of ratios			1:17	1:19	1:14	1:14	1:50	1:57
			÷	÷	÷	÷	÷	÷
			1:47	1:38	1:39	1:39	1:300	1:250
Hydraulic motor speed			high					
Max. input speed		rpm	3.000					
Braking torque		Nm	400 ÷ 1.000					
Design	Dimensions		B	B	B	A	B	B
		D1	250	300		300	340	370
		D2	280	425	320	425	400	470
		D3	380	460	500	460	510	600
		D4	420	500	560	500	560	640
		D5	345	400	425	428	445	542
		D6	17	22	22	22	22	22
		L1	295	360	70	345	420	465
L2	720	730	750	735	1.250	750		
Weight		kg	165	250	160	300	500	650

DRAWINGS

DESIGN A

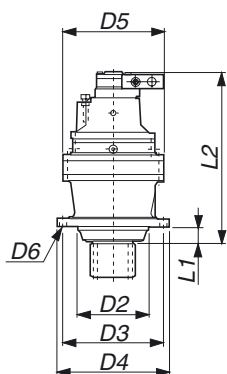

DESIGN B

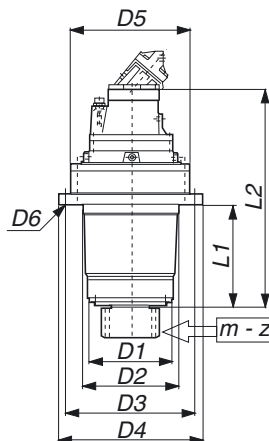

Information contained in this catalogue is accurate as of the publication date and is subject to change without notice. Performance values are typical values. Customers are responsible for selecting products for their applications using normal engineering methods.



# SMIT

hydraulics

**SMIT Hydraulics**

**Via Pietro Giardini, 318**  
**41100 Modena - ITALY**

[info@smithydraulics.it](mailto:info@smithydraulics.it)  
[www.smithydraulics.it](http://www.smithydraulics.it)

**PHONE**

+39 059 596 77 44  
+39 059 596 77 45

**FAX**

+39 059 596 08 80  
+39 059 596 08 88

**(Domestic market)**

**(International market)**